

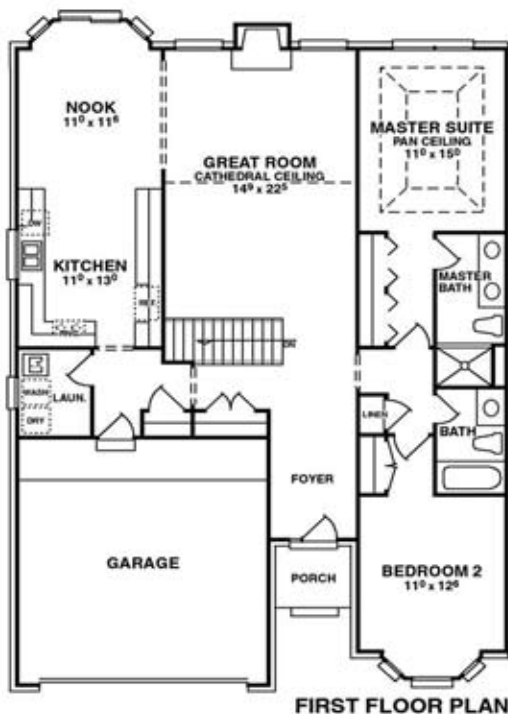

Decorated Models and Sales Information located on the South side of 21 Mile Road, Just West of Card Road.
Sales Office 586-469-1261 | Model Open Daily 12-6pm, Closed Thursday

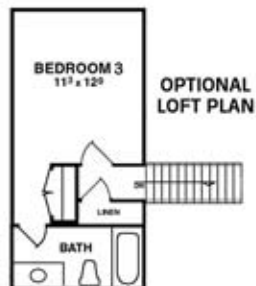

Prices, plans specifications and availability are subject to change without notice or obligation. MJC Fairway Commons LLC and architect copyright floor plans and elevations. Renderings are an artist's conception, and may vary in construction. Square feet and floor plan dimensions are approximate. © 2008

